

IMPORTANT
PLEASE DO NOT RETURN TO STORE
 If You're Having Trouble, We're Here to Help!



Call us 24/7 at 1-855-292-4087
 Email us at support@altec Lansing.com or visit us at altec Lansing.com

REGISTER YOUR PRODUCT

To receive news, exclusive deals, OTA or firmware updates, warranty information and more please register your product at

altec Lansing support.com



ALTEC LANSING

Follow us on social media:
 Facebook: @altec Lansing official
 Twitter: @altec Lansing
 Instagram: @altec Lansing official

12 Month Limited Warranty
 All Altec Lansing products come with 12 month limited warranty from the date of its original purchase

24 Hour Customer Support
 We love our customers and we care about your experience with Altec Lansing. If you need assistance, please call us at 1-855-292-4087 or e-mail support@altec Lansing.com
 www.altec Lansing.com

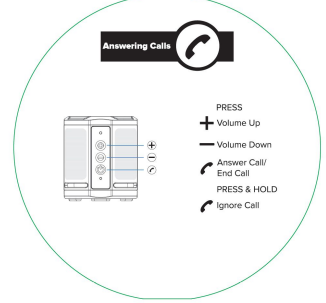
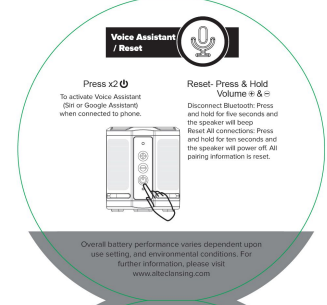
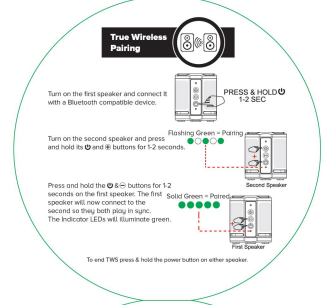
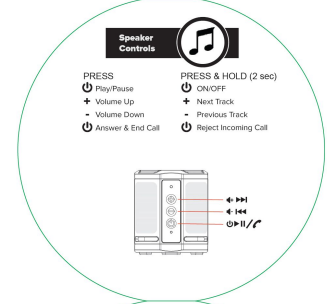
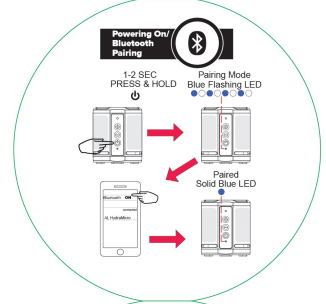
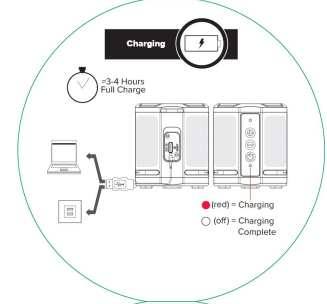
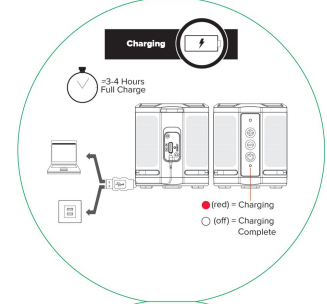
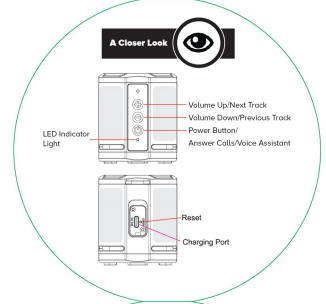
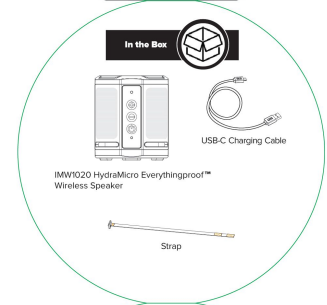
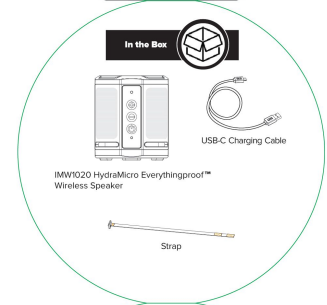

FOLLOW US ON
 #myaltec Lansing

Changes or modifications not expressly approved by the party responsible for compliance could void the safety instructions for this equipment. This device complies with Part 15 of the FCC Rules. Operation is subject to the following two conditions: (1) this device may not cause harmful interference, and (2) this device must accept any interference that may cause undesired operation.

This equipment has been tested and found to comply with the limits for a Class B digital device, pursuant to Part 15 of the FCC Rules. These limits are designed to provide reasonable protection against harmful interference in a residential environment. This equipment generates, uses, and can radiate radio frequency energy and, if not properly installed and used, may cause harmful interference to radio communications. However, there is no guarantee that interference will not occur in a particular installation.

If interference does occur, the user is encouraged to take the following steps: (1) reorient or relocate the receiving antenna; (2) increase the separation between the equipment and receiver; (3) connect the equipment into a circuit different from that to which the receiver is connected; (4) consult the dealer or an experienced radio/television technician for help.

This equipment complies with FCC radiation exposure limits set forth for an uncontrolled environment.

This transmitter must not be co-located or operating in conjunction with any other antenna or transmitter.

Sales International Inc.
 55 Center Drive
 55000, New Jersey 08817 USA
 855-292-4087
 www.altec Lansing.com